

BLIND FLANGE

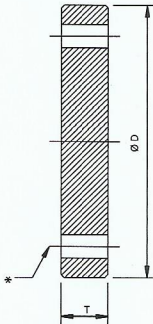
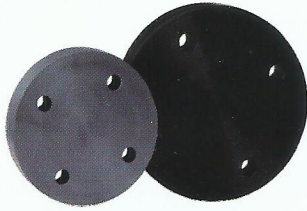

Note :

We will also provide in M.O.C.:
PVDF/PP-H & P.P.C.P. Natural,
for details & Prices Contact us.

ALL DIMENSIONS ARE IN MM (±2 MM)

SIZE		Ø D	T
IN.	MM.		
½ "	20	97.0	17.5
¾ "	25	102.0	17.5
1 "	32	113.0	19.0
1¼ "	40	123.5	19.0
1½ "	50	142.0	21.0
2 "	63	164.0	19.0
2½ "	75	184.0	21.0
3 "	90	202.5	19.0
4 "	110	228.0	22.0
5 "	125	266.0	23.0
5¼ "	140	291.0	24.5
6 "	160	305.0	24.5
7 "	180	318.0	26.0
8 "	200	358.0	27.5
9 "	225	390.0	27.0
10 "	250	416.0	29.0
11 "	280	422.0	26.5
12 "	315	489.0	29.0

AS PER IS : 8008 - 1976 (PART VII)
MAX. WORKING PRESSURE 10kg / cm²

AVAILABLE M.O.C. :

PP (POLYPROPYLENE)
HDPE (HIGH DENSITY POLYETHYLENE)
ISOTACTIC PP
PVDF (POLYVINYLIDENE FLUORIDE)

*** FLANGE DRILLED**

ANSI B 16.5 (150 CLASS)
BS 10 TABLE D
BS 10 TABLE E
BS 10 TABLE F
DIN. STD

THREAD / PIPEBORE FLANGE

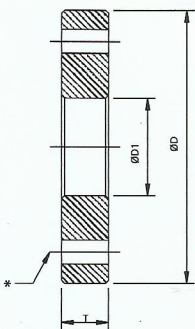

PIPEBORE FLANGE

ALL DIMENSIONS ARE IN MM (±2 MM)

SIZE		Ø D	Ø D1	T
IN.	MM.			
½ "	20	95.0	22	16.0
¾ "	25	101.0	27	17.5
1 "	32	122.5	34	18.5
1 ½ "	40	134.0	42	19.0
1 ¼ "	50	140.0	52	21.0
2 "	63	164.0	65	21.0
2 ½ "	75	184.0	77	21.0
3 "	90	202.5	92	22.0
4 "	110	228.0	112	22.5
5 "	125	266.0	127	23.0
5 ¼ "	140	263.0	142	24.5
6 "	160	298.5	162	25.5
7 "	180	329.0	182	27.0
8 "	200	375.0	202	30.0
9 "	225	398.0	227	32.5
10 "	250	427.0	252	30.5
11 "	280	451.0	282	32.0
12 "	315	489.0	317	29.0

AS PER IS : 8008 - 1976 (PART VII)
MAX. WORKING PRESSURE 10kg / cm²

AVAILABLE M.O.C. :

PP (POLYPROPYLENE)
ISOTACTIC PP
PVDF (POLYVINYLIDENE FLUORIDE)

Note :

We will also provide in M.O.C.:
PVDF/PP-H / P.P.C.P. Natural - HDPE
for bulk Quantity for details & Prices Contact us.

